

# RSA SECURID<sup>®</sup> ACCESS

## Implementation Guide

SproutVideo

Gina Salvazo, RSA Partner Engineering  
Last Modified: February 1, 2018

## Solution Summary

SproutVideo provides business video hosting solutions that are powerful, easy to use, and affordable. The platform makes it easy to upload video content, create a custom branded video player, add security features, and track video engagement and analytics. This integration supports both SP-initiated authentication as well as IDP-initiated flow. SproutVideo application also support auto-provisioning of the user.

RSA SecurID Access Features	
SproutVideo	
<b>On Premise Methods</b>	
RSA SecurID	✓
On Demand Authentication	✓
Risk-Based Authentication (AM)	-
<b>Cloud Authentication Service Methods</b>	
Authenticate App	✓
FIDO Token	✓
<b>SSO</b>	
SAML SSO	✓
HFED SSO	-
Identity Assurance	
Collect Device Assurance and User Behavior	✓

## Configuration Summary

---

All of the supported use cases of RSA SecurID Access with SproutVideo require both server-side and client-side configuration changes. This section of the guide includes links to the appropriate sections for configuring both sides for each use case.

**RSA Cloud Authentication Service** – SproutVideo can be integrated with RSA Cloud Authentication Service in the following way:

SAML via RSA Identity Router (IdP)

[Cloud Authentication Service – Identity Router IdP Configuration](#)

[SproutVideo SAML Configuration](#)

## RSA SecurID Access Server Side Configuration

### RSA Cloud Authentication Service Configuration

#### SAML via RSA Identity Router (IdP)

To configure a SAML Service Provider in RSA Identity Router, you must deploy the connector for SproutVideo in the RSA SecurID Access Console. During configuration of the IdP you will need some information from the SP. This information includes (but is not limited to) Assertion Consumer Service URL and Service Provider Entity ID.

#### Configure RSA Identity Router SAML IdP

##### Procedure

1. Logon to the RSA SecurID Access console and browse to **Applications > Application Catalog**, search for SproutVideo and click **+Add** to add the connector.



SproutVideo  
SAML Direct



2. Enter a name for the application for example *SproutVideo* in the **Name** field on the Basic Information page and click the **Next Step** button.
3. Navigate to Initiate SAML Workflow section.
4. Choose **IDP-initiated**

 **Note:** The following IdP-initiated configuration works for SP-initiated SproutVideo connections as well.

#### Initiate SAML Workflow

Connection URL 

IDP-initiated  SP-initiated

Binding Method for SAML Request

Redirect

POST

Signed 

 No certificate loaded

Choose File

Generate Cert Bundle

5. Scroll down to SAML Identity Provider (Issuer) section.

## SAML Identity Provider (Issuer)

---

Identity Provider URL ?

Issuer Entity ID ?

Default (idp\_id): rrfqzyzw31n

Override

SAML Response Signature ?

The identity router signs the SAML response with the private key, and the SP validates the signature with the corresponding certificate.

Private Key Loaded



Certificate Loaded

CN=gslab.com, Valid Until:  
01/08/2022

Include Certificate in Outgoing Assertion

- a. Make a note of **Identity Provider URL** field value, as it will be needed later to configure the Service Provider configuration.
- b. Select **Default (idp\_id)** for value for the **Issuer Entity ID**. Make sure that same **Issuer ID** is provided at SP-side SAML configuration.
- c. Select **Choose File** and upload the private key.
- d. Select **Choose File** to import the public signing certificate.
- e. Select the checkbox for **Include Certificate in Outgoing Assertion**.

6. Scroll down to the **Service Provider** section.

## Service Provider

Assertion Consumer Service (ACS) URL ?

https://<DOMAIN>.vids.io/saml/consume

Audience (Service Provider Entity ID) ?

<DOMAIN>.vids.io

- a. In the **Assertion Consumer Service (ACS) URL** field, replace <DOMAIN> with your account domain.
  - b. In the **Audience (Service Provider Issuer ID)** field, replace <DOMAIN> with your account domain.
6. Scroll down to the **User Identity** section. Verify the settings are correct for your environment. In this example the username is to be presented in email format and the user account will be validated against the User Store selected.

## User Identity ?

NameID

Identifier Type

Email Address

Identity Source

AD20

Property ?

mail

Attribute Hunting ?

NameID Attribute Hunting

7. Click **Next Step**.

- On the User Access page, select **Allow All Authenticated Users** user policy from the available options.

## Access Policy

---

Select the access policy to determine which users are allowed to access the application.

- Allow All Authenticated Users
- Select Custom Policy 

No Access Allowed 

- Click **Next Step**.
- On the **Portal Display** page, select **Display in Portal**.
- Click **Save and Finish**.
- Click **Publish Changes**. Your application is now enabled for SSO.

[Publish Changes](#)

Status:  Changes Pending

## Partner Product Configuration

### ***Before You Begin***

This section provides instructions for configuring the Interact with RSA SecurID Access. This document is not intended to suggest optimum installations or configurations.

It is assumed that the reader has both working knowledge of all products involved, and the ability to perform the tasks outlined in this section. Administrators should have access to the product documentation for all products in order to install the required components.

All SproutVideo components must be installed and working prior to the integration. Perform the necessary tests to confirm that this is true before proceeding.

### **SproutVideo SAML Configuration**

#### **Procedure**

1. Sign in to your SproutVideo application web account.  
<https://sproutvideo.com/login/>
2. Following UI will be displayed. Go to *VIDEO SITE* as shown in the image below and select *SITE SETTINGS*.

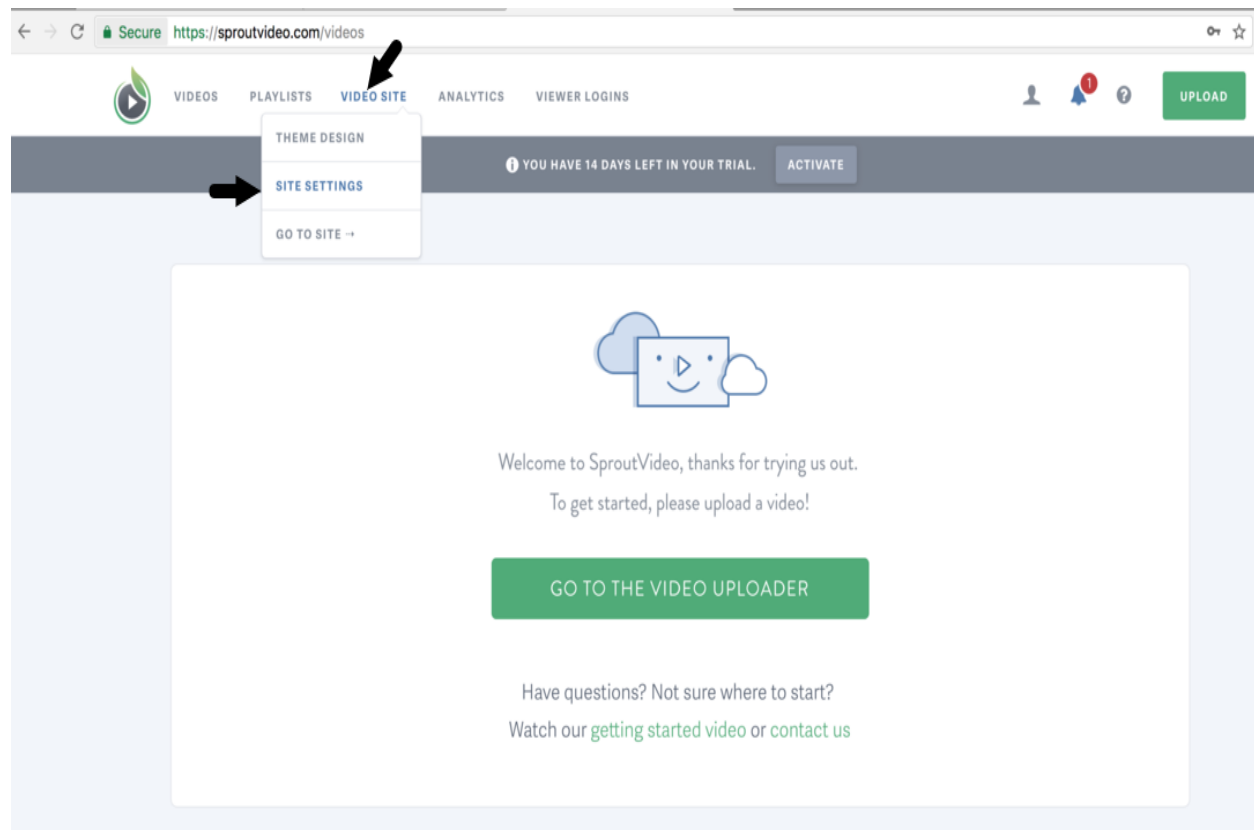



3. Following UI will be displayed. Go to *SSO Settings* and click on it.

Video Site Settings

Video Site Settings

Video Site URL ⓘ

https://<DOMAIN>.vids.io

CNAME ⓘ

Google Analytics ID ⓘ

Site Password ⓘ

Disable full site ⓘ

Allow logins to self-manage accounts ⓘ

SAVE SITE SETTINGS

4. Following UI will be displayed. Select **Enable SSO ON**.

Video Site Settings

SSO Settings

## SSO Settings

**ON** Enable SSO ⓘ

SAML SSO URL ⓘ

`https://portal.sso5.pe-lab.com/IdPServlet?idp_id=rrfqzyzw31n`

Note that our Assertion Consumer Service (ACS) URL is `https://[redacted].vids.io/saml/consume`

Certificate Fingerprint ⓘ

`6F:1C:09:DB:DB:86:AE:0E:1C:5D:B8:4E:76:A3:2D:14:30:92:4B:C9`

Remote logout URL ⓘ

`https://www.google.com/`

**SAVE SSO SETTINGS**

- a. **SAML SSO URL** : Enter the Identity Provider URL which can be found in step : 4 – a) on page – 5 of this document. It is of following format : [https://<Your\\_Portal\\_URL>?idp\\_id=<Unique\\_IdP\\_ID>](https://<Your_Portal_URL>?idp_id=<Unique_IdP_ID>).
  - b. **Certificate Fingerprint**: Provide identity provider public Certificate Fingerprint.
  - c. **Remote Logout URL**: Enter the URL where you want to reach after you logout from SproutVideo.
  - d. Once sure of all settings, click on **SAVE SSO SETTINGS** button to complete SAML configuration.
5. Your SproutVideo account is now enabled for SAML SSO authentication.